

C11-0098 TURNING LANE IMPROVEMENTS HOLCOMB BLVD

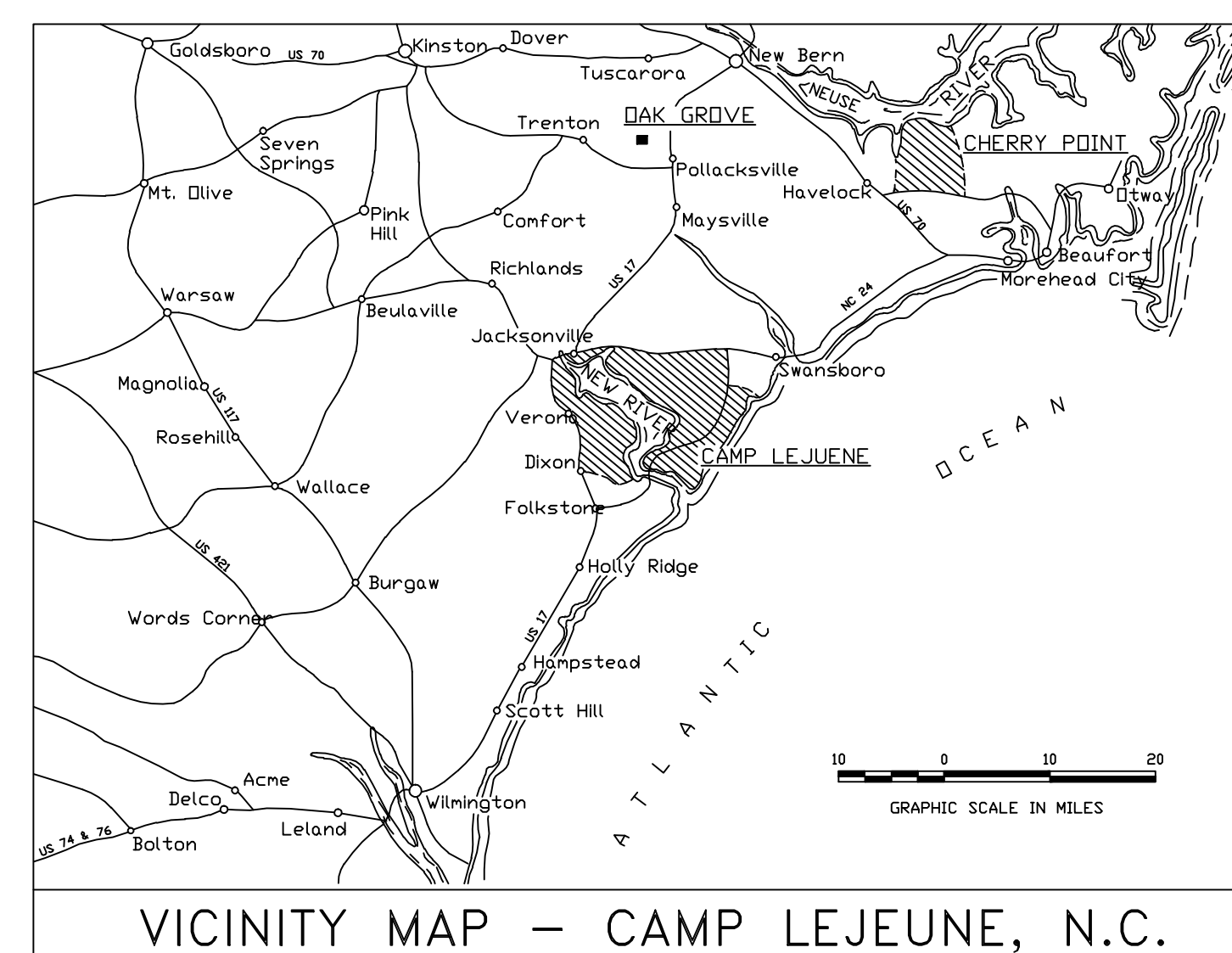

DRAWING INDEX		
NAVFAC DWG NO.	SHEET NO.	TITLE
60008021	T-1	LOCATION AND VICINITY MAP
60008022	C-1	SITE PLAN-HOLCOMB BLVD/BREWSTER BLVD
60008023	C-2	SITE PLAN-BLDG 1232 ENTRANCE
60008024	C-3	SITE PLAN-BLDG 1230 PARKING LOT EXIT
60008025	C-4	SITE PLAN-HOLCOMB BLVD/BIRCH ST
60008026	C-5	SITE PLAN-HOLCOMB BLVD/DOGWOOD RD
60008027	C-6	SITE PLAN-BLDG 84 RIGHT TURN LANE
60008028	C-7	SITE PLAN-BLDG 84 LEFT TURN LANE
60008029	C-8	DETAILS

T-1	
DEPARTMENT OF THE NAVY NAVAL FACILITIES ENGINEERING COMMAND MARINE CORPS BASE CAMP LEJEUNE, NORTH CAROLINA	
C11-0098 TURNING LANE IMPROVEMENTS HOLCOMB BLVD LOCATION AND VICINITY MAP	
DES. THOMAS BRADSHAW DR. THOMAS BRADSHAW CHK. DAVID TOWLER SUBMITTED BY: DAVID TOWLER DESIGN DIR. B. MARSHBURN, PE	PWO DRAWING NO. 60008021
DATE: 8/10/2011	SIZE CODE IDENT NO. F 80091
CONST. CONTR. NO. N40085-11-B-0098 SCALE: AS SHOWN SPEC. 05-11-0098	
SHEET 1 OF 9	



LEGEND	
EXISTING	NEW
CONCRETE CURBING	
ASPHALT	
ABBREVIATIONS	
AC	ASPHALTIC CONCRETE (ASPHALT)
ABC	AGGREGATE BASE COURSE
CD	CHECK DAM
UE	UNDERGROUND ELECTRIC
EW	EXISTING WATER LINE
NW	NEW WATER LINE
COM	COMMUNICATION LINE
TYP	TYPICAL
PP	POWER POLE
CP	CONTROL POINT
T	TELEPHONE
FO	FIBER OPTIC
MH	MAN HOLE
MW	MON. WELL
LP	LIGHT POLE
FM	FORCE MAIN
CMP	CORRUGATED METAL PIPE
ELEVATIONS	
	(95.52') (EXIST)
	96.2' (PROPOSED)

NOTES KEYED TO PLAN

- A EXTEND EXISTING HOLCOMB BLVD LEFT TURN LANE 200'. EXISTING TURNING LANE TAPER IS TO BE MAINTAINED.

GENERAL NOTES:

1. CONTRACTOR SHALL LOCATE ALL UNDERGROUND UTILITIES PRIOR TO GROUND DISTURBING ACTIVITIES.
2. CONTRACTOR SHALL COORDINATE ALL CONSTRUCTION ACTIVITIES WITH ROICC.
3. MAINTAIN EXISTING ROADWAY CROWN ON NEW SECTION OF TURN LANE FOR PROPER DRAINAGE.
4. COMPACT SUBBASE TO 95% AND INSTALL 8" OF COMPACTED ABC CRUSHED STONE (NCDOT COMPLIANT) IN 4" LIFTS. TOTAL PAVED AREA APPROX. 245 SQ YDS.
5. THE CONTRACTOR SHALL INSTALL NEW ROAD IN ACCORDANCE WITH TYPICAL NEW ROAD SECTION ON SHEET C8.
6. SAW CUT EDGE OF EXISTING PAVEMENT TO ALLOW FOR SMOOTH TRANSITION FROM NEW TO EXISTING PAVEMENT.
7. CONTRACTOR SHALL BE RESPONSIBLE FOR ALL TRAFFIC CONTROL NECESSARY TO SAFELY CONDUCT CONSTRUCTION ACTIVITIES. SURROUNDING BUILDINGS WILL REMAIN IN OPERATION DURING THE ENTIRE CONSTRUCTION PERIOD. THE CONTRACTOR SHALL CONDUCT OPERATIONS SO AS TO CAUSE THE LEAST POSSIBLE INTERFERENCE WITH NORMAL OPERATIONS TO THE MAXIMUM EXTENT POSSIBLE. CONTRACTOR SHALL COORDINATE TRAFFIC CONTROL WITH BASE PMO (451-8381) THROUGH ROICC.
8. THE CONTRACTOR SHALL PROVIDE ALL PAVEMENT MARKINGS AS REQUIRED BY NCDOT STANDARD SPECIFICATIONS FOR ROADS AND STRUCTURES (JULY 2006) SECTION 1205. PAVEMENT MARKINGS WILL INCLUDE CENTERLINES, DIRECTIONAL ARROWS, ETC. SEE PAVEMENT MARKING DETAIL AND TRAFFIC DIRECTIONAL ARROW DETAIL ON SHEET C3. PAVEMENT MARKINGS SHALL BE PAINTED WITH WHITE HIGH BUILD ACRYLIC COATING TRAFFIC PAINT.
9. TURN LANE ARROWS ARE TO BE PROVIDED EVERY 100' FOR LANES MORE THAN 250' AND EVERY 75' FOR TURNS LANES LESS THAN 250'.
10. REMOVE/REPLACE WHITE HIGH BUILD ACRYLIC EDGE LINES/SKIP LINES TO COMPENSATE FOR LENGTHENING OF TURN LANE.
11. SEED ANY DISTURBED AREAS IN ACCORDANCE WITH BASE SEEDING SCHEDULE UPON COMPLETION OF CONSTRUCTION.
12. NO SECTION 404 WETLANDS WITHIN PROJECT BOUNDARIES.
13. JOBSITE SHALL BE KEPT CLEAR OF ALL DEBRIS AND TRASH.

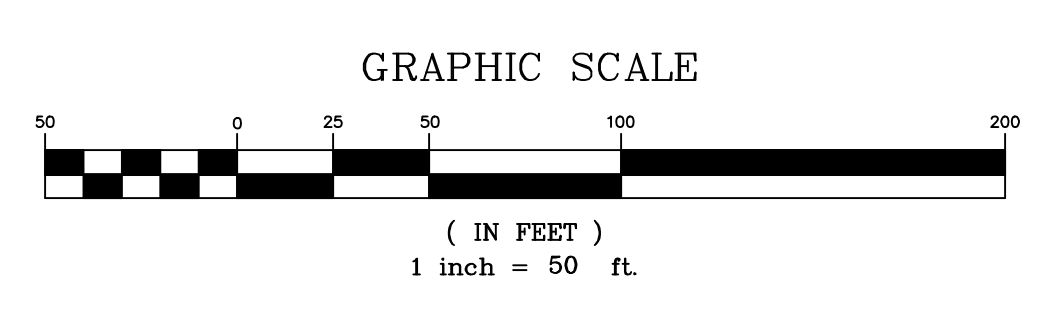

SITE PLAN-HOLCOMB BLVD AT BREWSTER BLVD

C-1	
DEPARTMENT OF THE NAVY NAVAL FACILITIES ENGINEERING COMMAND MARINE CORPS BASE CAMP LEJEUNE, NORTH CAROLINA	
C11-0098	
TURNING LANE IMPROVEMENTS HOLCOMB BLVD	
HOLCOMB BLVD/BREWSTER BLVD	
DES. THOMAS BRADSHAW	
DR. THOMAS BRADSHAW	
CHK. DAVID TOWLER	
SUBMITTED BY: DAVID TOWLER	
DESIGN DIR. B. R. MARSHBURN, PE	
DATE: 8/10/2011	
SIZE CODE IDENT NO. F 80091	PWO DRAWING NO. 60008022
CONST. CONTR. NO. N62470-11-B-0098	
SCALE: AS SHOWN SPEC. 05-11-0098	SHEET 2 OF 9

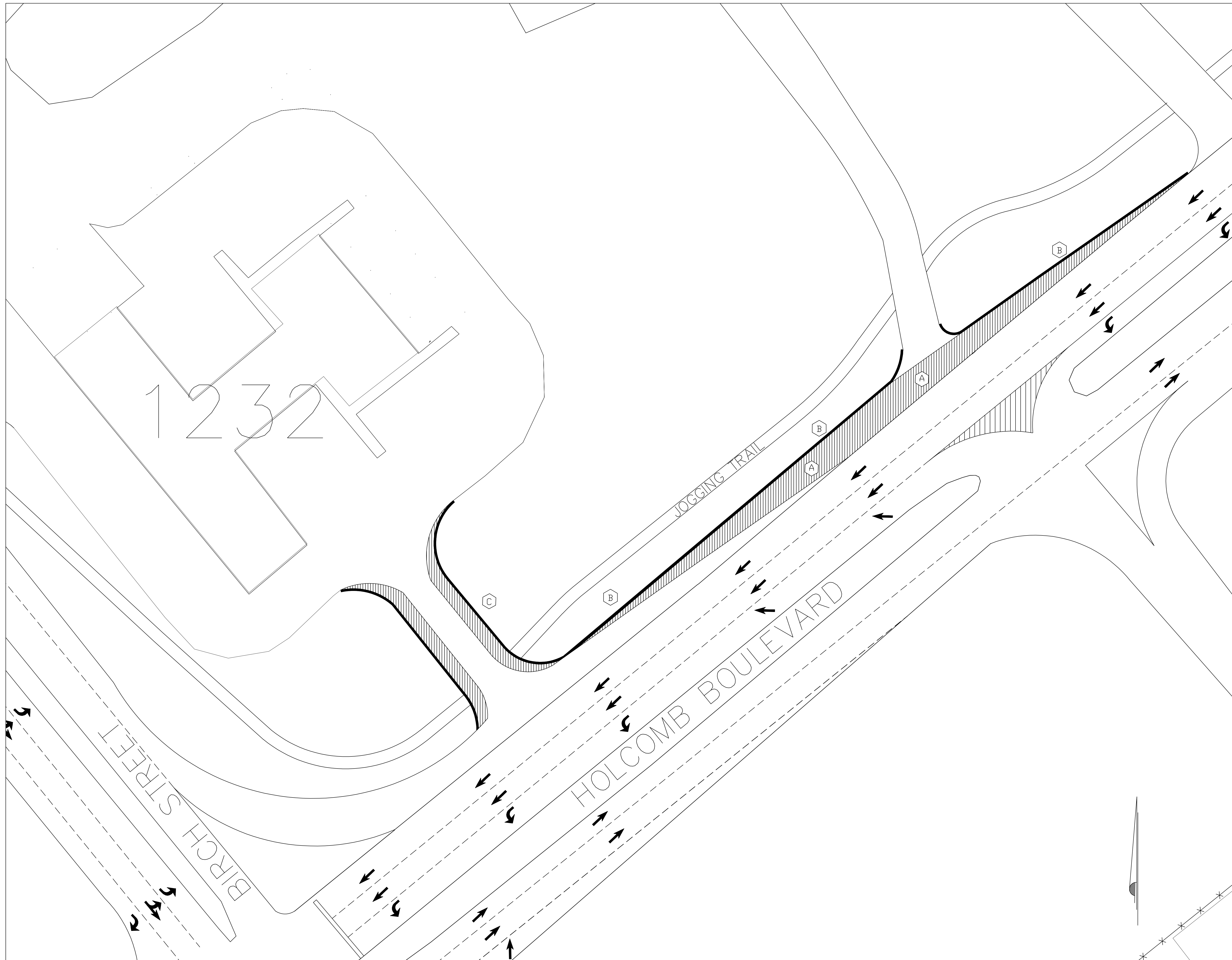

LEGEND	
EXISTING	NEW
CONCRETE CURBING	
ASPHALT	

ABBREVIATIONS	
AC	ASPHALTIC CONCRETE (ASPHALT)
ABC	AGGREGATE BASE COURSE
CD	CHECK DAM
UE	UNDERGROUND ELECTRIC
EW	EXISTING WATER LINE
NW	NEW WATER LINE
COM	COMMUNICATION LINE
TYP	TYPICAL
PP	POWER POLE
CP	CONTROL POINT
T	TELEPHONE
FO	FIBER OPTIC
MH	MAN HOLE
MW	MON. WELL
LP	LIGHT POLE
FM	FORCE MAIN
CMP	CORRUGATED METAL PIPE

ELEVATIONS	
	(EXIST)
	PROPOSED

NOTES KEYED TO PLAN

- A** EXTEND EXISTING RIGHT TURN LANE INTO BLDG 1232 BY 200 LF WITH A 180' TAPER. STRIPE TO MATCH EXISTING BROKEN WHITE LINE.
- B** PROVIDE APPROX 440 LF OF NEW CURBING TO RUN ENTIRE LENGTH OF RIGHT TURN LANE. PROVIDE CURB CUTS EVERY 20' FOR DRAINAGE RELIEF. WHERE CURBING MEETS EXISTING DIRT ROAD, EXTEND CURBING TO EDGE OF JOGGING TRAIL. SEE SHEET C8 FOR ASSOCIATED DETAIL.
- C** WIDEN EXISTING DRIVEWAY ENTRANCE TO BLDG 1232 OFF OF HOLCOMB BLVD BY 15' (OFFSET 7.5' ON EITHER SIDE OF EXISTING ENTRANCE DRIVE). DEMO AND REPLACE ALL EXISTING CURBING. MAINTAIN ALL EXISTING CURVE RADII.

GENERAL NOTES:

1. CONTRACTOR SHALL LOCATE ALL UNDERGROUND UTILITIES PRIOR TO GROUND DISTURBING ACTIVITIES.
2. CONTRACTOR SHALL COORDINATE ALL CONSTRUCTION ACTIVITIES WITH ROICC.
3. MAINTAIN EXISTING ROADWAY CROWN ON NEW SECTION OF TURN LANE FOR PROPER DRAINAGE.
4. COMPACT SUBBASE TO 95% AND INSTALL 8" OF COMPACTED ABC CRUSHED STONE (NCDOT COMPLIANT) IN 4" LIFTS. TOTAL PAVED AREA APPROX. 475 SQ YDS.
5. THE CONTRACTOR SHALL INSTALL NEW ROAD IN ACCORDANCE WITH TYPICAL NEW ROAD SECTION ON SHEET C8.
6. SAW CUT EDGE OF EXISTING PAVEMENT TO ALLOW FOR SMOOTH TRANSITION FROM NEW TO EXISTING PAVEMENT.
7. CONTRACTOR SHALL BE RESPONSIBLE FOR ALL TRAFFIC CONTROL NECESSARY TO SAFELY CONDUCT CONSTRUCTION ACTIVITIES. SURROUNDING BUILDINGS WILL REMAIN IN OPERATION DURING THE ENTIRE CONSTRUCTION PERIOD. THE CONTRACTOR SHALL CONDUCT OPERATIONS SO AS TO CAUSE THE LEAST POSSIBLE INTERFERENCE WITH NORMAL OPERATIONS TO THE MAXIMUM EXTENT POSSIBLE. CONTRACTOR SHALL COORDINATE TRAFFIC CONTROL WITH BASE PMO (451-8381) THROUGH ROICC.
8. THE CONTRACTOR SHALL PROVIDE ALL PAVEMENT MARKINGS AS REQUIRED BY NCDOT STANDARD SPECIFICATIONS FOR ROADS AND STRUCTURES (JULY 2006) SECTION 1205. PAVEMENT MARKINGS WILL INCLUDE CENTERLINES, DIRECTION ARROWS, ETC. SEE PAVEMENT MARKING DETAIL AND TRAFFIC DIRECTIONAL ARROW DETAIL ON SHEET C3. PAVEMENT MARKINGS SHALL BE PAINTED WITH WHITE HIGH BUILD ACRYLIC COATING TRAFFIC PAINT.
9. TURN LANE ARROWS ARE TO BE PROVIDED EVERY 100' FOR LANES MORE THAN 250' AND EVERY 75' FOR TURNS LANES LESS THAN 250'.
10. REMOVE/REPLACE WHITE HIGH BUILD ACRYLIC EDGE LINES/SKIP LINES TO COMPENSATE FOR LENGTHENING OF TURN LANE.
11. SEED ANY DISTURBED AREAS IN ACCORDANCE WITH BASE SEEDING SCHEDULE UPON COMPLETION OF CONSTRUCTION.
12. NO SECTION 404 WETLANDS WITHIN PROJECT BOUNDARIES.
13. JOBSITE SHALL BE KEPT CLEAR OF ALL DEBRIS AND TRASH.

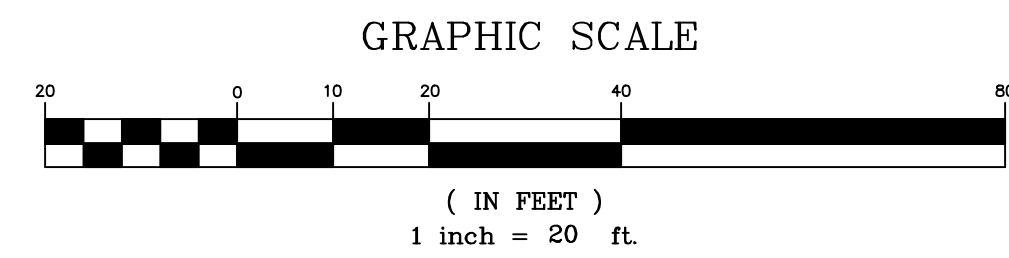

SITE PLAN-BLDG 1232 TURNING LANE

C-2

DEPARTMENT OF THE NAVY NAVAL FACILITIES ENGINEERING COMMAND	
MARINE CORPS BASE	
CAMP LEJEUNE, NORTH CAROLINA	
C11-0098	
TURNING LANE IMPROVEMENTS	
HOLCOMB BLVD	
BLDG 1232 ENTRANCE	
DESIGN DIR. B. R. MARSHBURN, PE	PWO DRAWING NO. 60008023
DATE: 8/10/2011	SIZE CODE IDENT NO. F 80091
CONST. CONTR. NO. N62470-11-B-0098	
SCALE: AS SHOWN SPEC. 05-11-0098	SHEET 3 OF 9

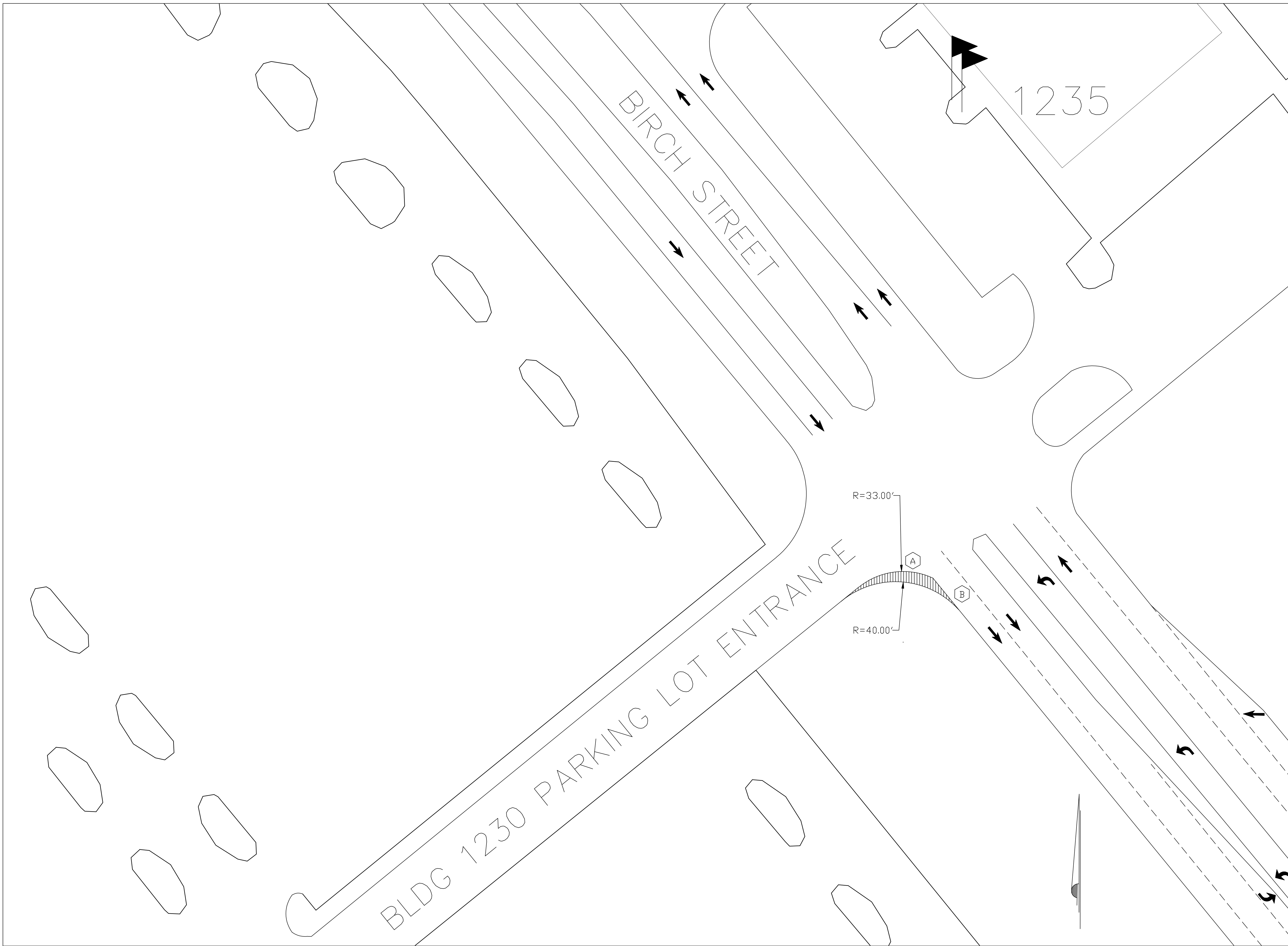

LEGEND	
EXISTING	NEW
CONCRETE CURBING	
ASPHALT	

ABBREVIATIONS	
AC	ASPHALTIC CONCRETE (ASPHALT)
ABC	AGGREGATE BASE COURSE
CD	CHECK DAM
UE	UNDERGROUND ELECTRIC
EW	EXISTING WATER LINE
NW	NEW WATER LINE
COM	COMMUNICATION LINE
TYP	TYPICAL
PP	POWER POLE
CP	CONTROL POINT
T	TELEPHONE
FO	FIBER OPTIC
MH	MAN HOLE
MW	MON. WELL
LP	LIGHT POLE
FM	FORCE MAIN
CMP	CORRUGATED METAL PIPE

ELEVATIONS	
	(EXIST)
	PROPOSED

- NOTES KEYED TO PLAN**
- A** ENLARGE EXISTING CURVE RADIUS FOR PARKING LOT EXIT FROM 33' TO 40'. DEMO AND REPLACE 70' OF CURBING AND APPROX. 5 LF OF EXISTING SIDEWALK.
 - B** EXTEND CURBING 10 LF ALONG BIRCH ST TOWARD HOLCOMB BLVD. SEE SHEET C8 FOR ASSOCIATED DETAIL.

- GENERAL NOTES:**
1. CONTRACTOR SHALL LOCATE ALL UNDERGROUND UTILITIES PRIOR TO GROUND DISTURBING ACTIVITIES.
 2. CONTRACTOR SHALL COORDINATE ALL CONSTRUCTION ACTIVITIES WITH ROICC.
 3. MAINTAIN EXISTING ROADWAY CROWN ON NEW SECTION OF TURN LANE FOR PROPER DRAINAGE.
 4. COMPACT SUBBASE TO 95% AND INSTALL 8" OF COMPACTED ABC CRUSHED STONE (NCDOT COMPLIANT) IN 4" LIFTS. TOTAL PAVED AREA APPROX. 25 SQ YDS.
 5. THE CONTRACTOR SHALL INSTALL NEW ROAD IN ACCORDANCE WITH TYPICAL NEW ROAD SECTION ON SHEET C8.
 6. CONTRACTOR SHALL BE RESPONSIBLE FOR ALL TRAFFIC CONTROL NECESSARY TO SAFELY CONDUCT CONSTRUCTION ACTIVITIES. SURROUNDING BUILDINGS WILL REMAIN IN OPERATION DURING THE ENTIRE CONSTRUCTION PERIOD. THE CONTRACTOR SHALL CONDUCT OPERATIONS SO AS TO CAUSE THE LEAST POSSIBLE INTERFERENCE WITH NORMAL OPERATIONS TO THE MAXIMUM EXTENT POSSIBLE. CONTRACTOR SHALL COORDINATE TRAFFIC CONTROL WITH BASE PMO (451-8381) THROUGH ROICC.
 7. SEED ANY DISTURBED AREAS IN ACCORDANCE WITH BASE SEEDING SCHEDULE UPON COMPLETION OF CONSTRUCTION.
 8. NO SECTION 404 WETLANDS WITHIN PROJECT BOUNDARIES.
 9. JOBSITE SHALL BE KEPT CLEAR OF ALL DEBRIS AND TRASH.

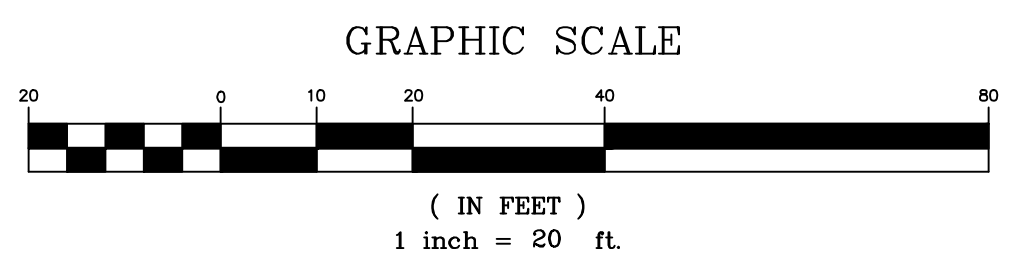

SITE PLAN-BLDG 1230 TURNING LANE

		C-3	
		DEPARTMENT OF THE NAVY NAVAL FACILITIES ENGINEERING COMMAND	
		MARINE CORPS BASE	
		CAMP LEJEUNE, NORTH CAROLINA	
		C11-0098	
		TURNING LANE IMPROVEMENTS	
		HOLCOMB BLVD	
		BLDG 1230 PARKING LOT EXIT	
DES. THOMAS BRADSHAW	DR. THOMAS BRADSHAW	CHK. DAVID TOWLER	DATE: 8/10/2011
SUBMITTED BY: DAVID TOWLER		DESIGN DIR. B. R. MARSHBURN, PE	SIZE CODE IDENT NO. F 80091
		PWO DRAWING NO. 60008024	CONST. CONTR. NO. N62470-11-B-0098
		SCALE: AS SHOWN SPEC. 05-11-0098	SHEET 4 OF 9

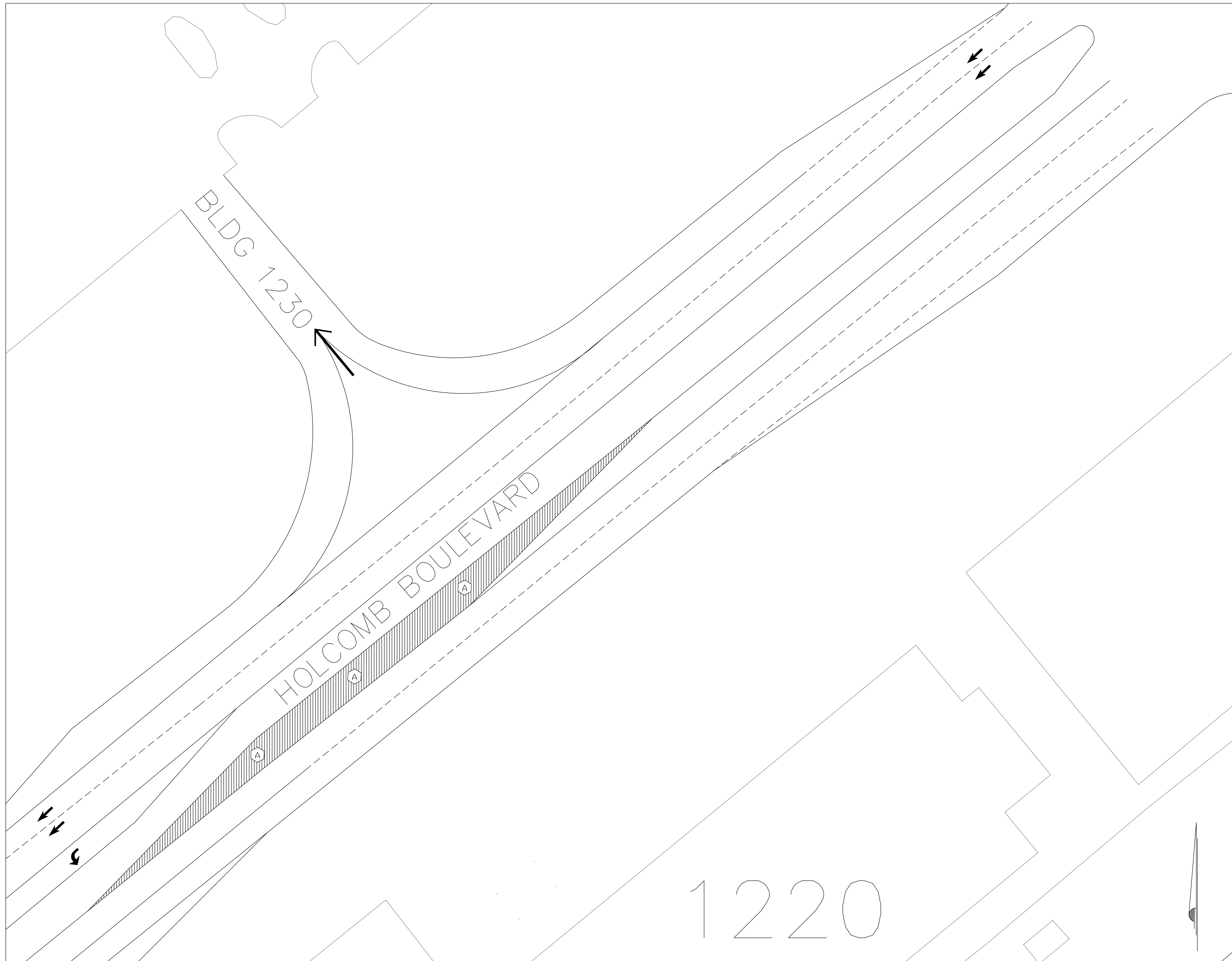

LEGEND	
EXISTING	NEW
CONCRETE CURBING	
ASPHALT	

ABBREVIATIONS	
AC	ASPHALTIC CONCRETE (ASPHALT)
ABC	AGGREGATE BASE COURSE
CD	CHECK DAM
UE	UNDERGROUND ELECTRIC
EW	EXISTING WATER LINE
NW	NEW WATER LINE
COM	COMMUNICATION LINE
TYP	TYPICAL
PP	POWER POLE
CP	CONTROL POINT
T	TELEPHONE
FO	FIBER OPTIC
MH	MAN HOLE
MW	MON. WELL
LP	LIGHT POLE
FM	FORCE MAIN
CMP	CORRUGATED METAL PIPE

ELEVATIONS	
	(EXIST)
	PROPOSED

NOTES KEYED TO PLAN

A EXTEND EXISTING HOLCOMB BLVD LEFT TURN LANE 250'. PROVIDE 120' TAPER ON TURN LANE.

- GENERAL NOTES:**
- CONTRACTOR SHALL LOCATE ALL UNDERGROUND UTILITIES PRIOR TO GROUND DISTURBING ACTIVITIES.
 - CONTRACTOR SHALL COORDINATE ALL CONSTRUCTION ACTIVITIES WITH ROICC.
 - MAINTAIN EXISTING ROADWAY CROWN ON NEW SECTION OF LEFT TURN LANE FOR PROPER DRAINAGE.
 - COMPACT SUBBASE TO 95% AND INSTALL 8" OF COMPACTED ABC CRUSHED STONE (NCDOT COMPLIANT) IN 4" LIFTS. TOTAL PAVED AREA APPROX. 380 SQ YDS.
 - THE CONTRACTOR SHALL INSTALL NEW ROAD IN ACCORDANCE WITH TYPICAL NEW ROAD SECTION ON SHEET C8.
 - SAW CUT EDGE OF EXISTING PAVEMENT TO ALLOW FOR SMOOTH TRANSITION FROM NEW TO EXISTING PAVEMENT.
 - CONTRACTOR SHALL BE RESPONSIBLE FOR ALL TRAFFIC CONTROL NECESSARY TO SAFELY CONDUCT CONSTRUCTION ACTIVITIES. SURROUNDING BUILDINGS WILL REMAIN IN OPERATION DURING THE ENTIRE CONSTRUCTION PERIOD. THE CONTRACTOR SHALL CONDUCT OPERATIONS SO AS TO CAUSE THE LEAST POSSIBLE INTERFERENCE WITH NORMAL OPERATIONS TO THE MAXIMUM EXTENT POSSIBLE. CONTRACTOR SHALL COORDINATE TRAFFIC CONTROL WITH BASE PMO (451-8381) THROUGH ROICC.
 - THE CONTRACTOR SHALL PROVIDE ALL PAVEMENT MARKINGS AS REQUIRED BY NCDOT STANDARD SPECIFICATIONS FOR ROADS AND STRUCTURES (JULY 2006) SECTION 1205. PAVEMENT MARKINGS WILL INCLUDE CENTERLINES, DIRECTIONAL ARROWS, ETC. SEE PAVEMENT MARKING DETAIL AND TRAFFIC DIRECTIONAL ARROW DETAIL ON SHEET C3. PAVEMENT MARKINGS SHALL BE PAINTED WITH WHITE HIGH BUILD ACRYLIC COATING TRAFFIC PAINT.
 - TURN LANE ARROWS ARE TO BE PROVIDED EVERY 100' FOR LANES MORE THAN 250' AND EVERY 75' FOR TURNS LANES LESS THAN 250'.
 - REMOVE/REPLACE WHITE HIGH BUILD ACRYLIC EDGE LINES/SKIP LINES TO COMPENSATE FOR LENGTHENING OF TURN LANE.
 - SEED ANY DISTURBED AREAS IN ACCORDANCE WITH BASE SEEDING SCHEDULE UPON COMPLETION OF CONSTRUCTION.
 - NO SECTION 404 WETLANDS WITHIN PROJECT BOUNDARIES.
 - JOBSITE SHALL BE KEPT CLEAR OF ALL DEBRIS AND TRASH.

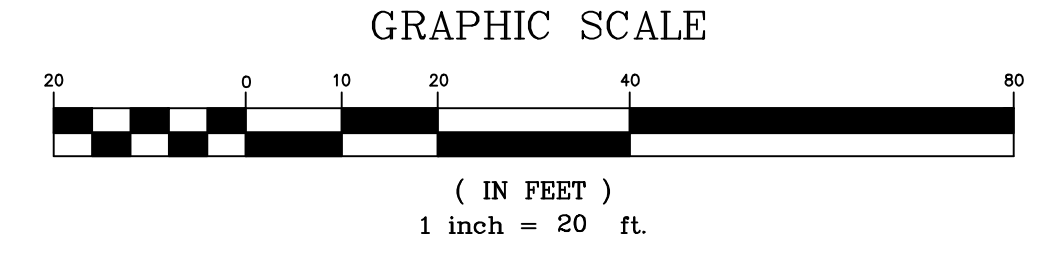

SITE PLAN—HOLCOMB BLVD/BIRCH ST INTERSECTION

C-4	
DEPARTMENT OF THE NAVY NAVAL FACILITIES ENGINEERING COMMAND MARINE CORPS BASE CAMP LEJEUNE, NORTH CAROLINA	
C11-0098 TURNING LANE IMPROVEMENTS HOLCOMB BLVD HOLCOMB BLVD/BIRCH ST	
DES. THOMAS BRADSHAW	
DR. THOMAS BRADSHAW	
CHK. DAVID TOWLER	
SUBMITTED BY: DAVID TOWLER	
DESIGN DIR. B. R. MARSHBURN, PE	
DATE: 8/10/2011	SIZE CODE IDENT NO. PWO DRAWING NO. F 80091 60008025
SCALE: AS SHOWN SPEC. 05-11-0098 SHEET 5 OF 9	



LEGEND	
EXISTING	NEW
	CONCRETE CURBING
	ASPHALT
ABBREVIATIONS	
AC	ASPHALTIC CONCRETE (ASPHALT)
ABC	AGGREGATE BASE COURSE
CD	CHECK DAM
UE	UNDERGROUND ELECTRIC
EW	EXISTING WATER LINE
NW	NEW WATER LINE
COM	COMMUNICATION LINE
TYP	TYPICAL
PP	POWER POLE
CP	CONTROL POINT
T	TELEPHONE
FO	FIBER OPTIC
MH	MAN HOLE
MW	MON. WELL
LP	LIGHT POLE
FM	FORCE MAIN
CMP	CORRUGATED METAL PIPE
ELEVATIONS	
	(95.52')
	96.2'
	(EXIST)
	PROPOSED

NOTES KEYED TO PLAN

- A EXTEND EXISTING HOLCOMB BLVD LEFT TURN LANE 200'. PROVIDE NEW 120' TAPER ON TURN LANE.

GENERAL NOTES:

- CONTRACTOR SHALL LOCATE ALL UNDERGROUND UTILITIES PRIOR TO GROUND DISTURBING ACTIVITIES.
- CONTRACTOR SHALL COORDINATE ALL CONSTRUCTION ACTIVITIES WITH ROICC.
- MAINTAIN EXISTING ROADWAY CROWN OF 2% ON NEW SECTION OF TURN LANE FOR PROPER DRAINAGE.
- COMPACT SUBBASE TO 95% AND INSTALL 8" OF COMPACTED ABC CRUSHED STONE (NCDOT COMPLIANT) IN 4" LIFTS. TOTAL PAVED AREA APPROX. 250 SQ YDS.
- THE CONTRACTOR SHALL INSTALL NEW ROAD IN ACCORDANCE WITH TYPICAL NEW ROAD SECTION ON SHEET C3.
- SAW CUT EDGE OF EXISTING PAVEMENT TO ALLOW FOR SMOOTH TRANSITION FROM NEW TO EXISTING PAVEMENT.
- CONTRACTOR SHALL BE RESPONSIBLE FOR ALL TRAFFIC CONTROL NECESSARY TO SAFELY CONDUCT CONSTRUCTION ACTIVITIES. SURROUNDING BUILDINGS WILL REMAIN IN OPERATION DURING THE ENTIRE CONSTRUCTION PERIOD. THE CONTRACTOR SHALL CONDUCT OPERATIONS SO AS TO CAUSE THE LEAST POSSIBLE INTERFERENCE WITH NORMAL OPERATIONS TO THE MAXIMUM EXTENT POSSIBLE. CONTRACTOR SHALL COORDINATE TRAFFIC CONTROL WITH BASE PMO (451-8381) THROUGH ROICC.
- THE CONTRACTOR SHALL PROVIDE ALL PAVEMENT MARKINGS AS REQUIRED BY NCDOT STANDARD SPECIFICATIONS FOR ROADS AND STRUCTURES (JULY 2006) SECTION 1205. PAVEMENT MARKINGS WILL INCLUDE CENTERLINES, DIRECTION ARROWS, ETC. SEE PAVEMENT MARKING DETAIL AND TRAFFIC DIRECTIONAL ARROW DETAIL ON SHEET C3. PAVEMENT MARKINGS SHALL BE PAINTED WITH HIGH BUILD ACRYLIC COATING TRAFFIC PAINT IN COLOR SPECIFIED.
- TURN LANE ARROWS ARE TO BE PROVIDED EVERY 100' FOR LANES MORE THAN 250' AND EVERY 75' FOR TURNS LANES LESS THAN 250'.
- REMOVE/REPLACE WHITE HIGH BUILD ACRYLIC EDGE LINES/SKIP LINES TO COMPENSATE FOR LENGTHENING OF TURN LANE.
- SEED ANY DISTURBED AREAS IN ACCORDANCE WITH BASE SEEDING SCHEDULE UPON COMPLETION OF CONSTRUCTION.
- NO SECTION 404 WETLANDS WITHIN PROJECT BOUNDARIES.
- JOBSITE SHALL BE KEPT CLEAR OF ALL DEBRIS AND TRASH.

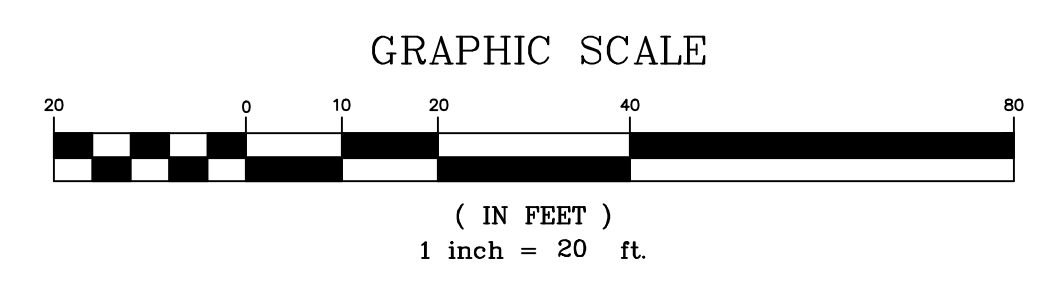

SITE PLAN-HOLCOMB BLVD/DOGWOOD ST INTERSECTION

		C-5	
		DEPARTMENT OF THE NAVY NAVAL FACILITIES ENGINEERING COMMAND MARINE CORPS BASE CAMP LEJEUNE, NORTH CAROLINA	
		C11-0098	
		TURNING LANE IMPROVEMENTS HOLCOMB BLVD	
		HOLCOMB BLVD/DOGWOOD ST	
DES. THOMAS BRADSHAW		SIZE	CODE IDENT NO.
DR. THOMAS BRADSHAW		8/10/2011	F 80091
CHK. DAVID TOWLER			PWO DRAWING NO.
SUBMITTED BY: DAVID TOWLER			60008026
DATE: 8/10/2011			CONST. CONTR. NO. N62470-11-B-0098
		SCALE: AS SHOWN SPEC. 05-11-0098	SHEET 6 OF 9

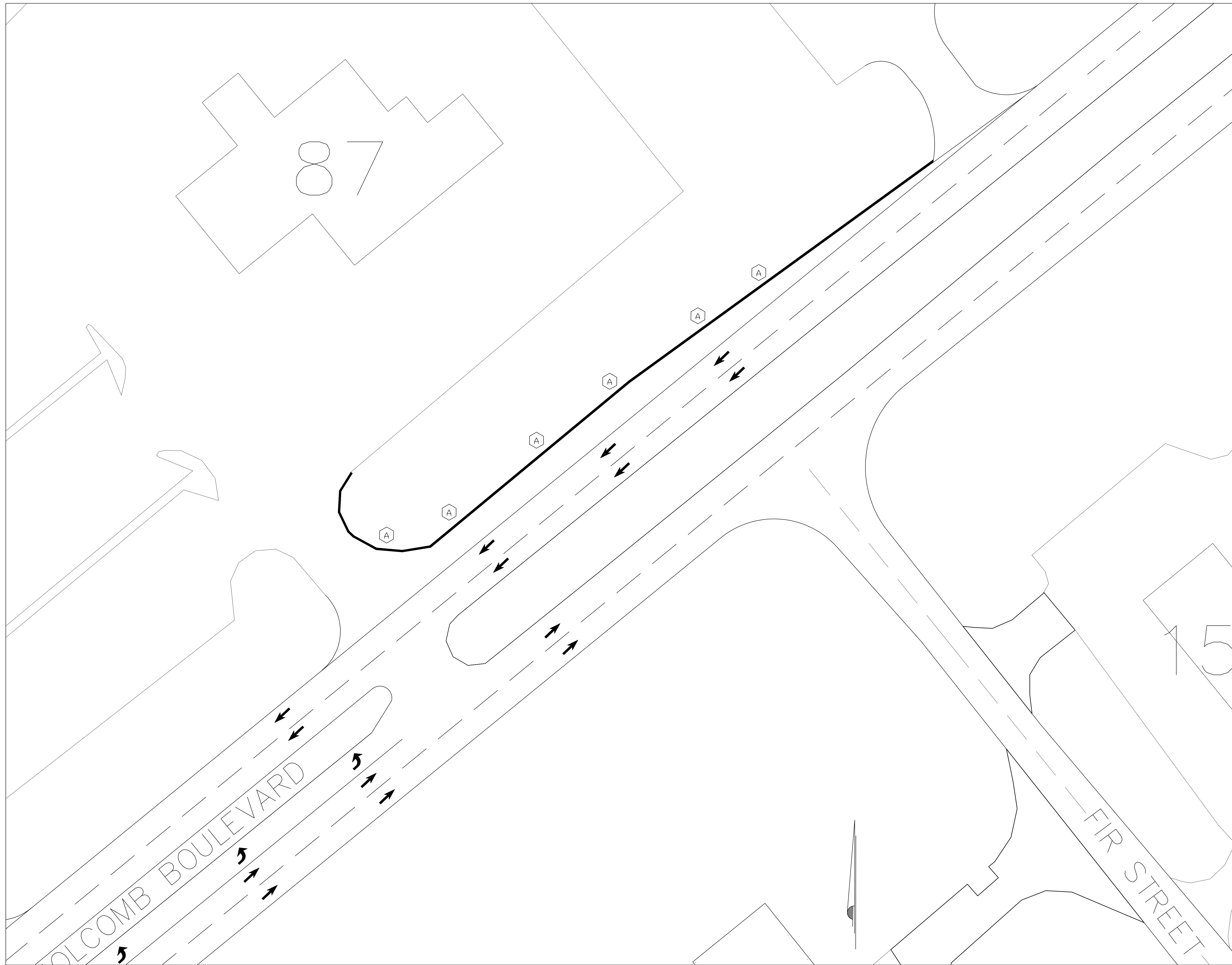

LEGEND	
EXISTING	NEW
CONCRETE CURBING	
ASPHALT	
ABBREVIATIONS	
AC	ASPHALTIC CONCRETE (ASPHALT)
ABC	AGGREGATE BASE COURSE
CD	CHECK DAM
UE	UNDERGROUND ELECTRIC
EW	EXISTING WATER LINE
NW	NEW WATER LINE
COM	COMMUNICATION LINE
TYP.	TYPICAL
PP	POWER POLE
CP	CONTROL POINT
T	TELEPHONE
FO	FIBER OPTIC
MH	MAN HOLE
MW	MON. WELL
LP	LIGHT POLE
FM	FORCE MAIN
CMP	CORRUGATED METAL PIPE
ELEVATIONS	
(95.52')	(EXIST)
96.2'	PROPOSED

NOTES KEYED TO PLAN

(A) PROVIDE 390 LF OF NEW CURB AND GUTTER TO RUN ENTIRE LENGTH OF TURNING LANE. PROVIDE CURB CUTS EVERY 20' FOR DRAINAGE RELIEF. SEE SHEET C8 FOR ASSOCIATED DETAILS.

- GENERAL NOTES:**
- CONTRACTOR SHALL LOCATE ALL UNDERGROUND UTILITIES PRIOR TO GROUND DISTURBING ACTIVITIES.
 - CONTRACTOR SHALL COORDINATE ALL CONSTRUCTION ACTIVITIES WITH ROICC.
 - CONTRACTOR SHALL BE RESPONSIBLE FOR ALL TRAFFIC CONTROL NECESSARY TO SAFELY CONDUCT CONSTRUCTION ACTIVITIES. SURROUNDING BUILDINGS WILL REMAIN IN OPERATION DURING THE ENTIRE CONSTRUCTION PERIOD. THE CONTRACTOR SHALL CONDUCT OPERATIONS SO AS TO CAUSE THE LEAST POSSIBLE INTERFERENCE WITH NORMAL OPERATIONS TO THE MAXIMUM EXTENT POSSIBLE. CONTRACTOR SHALL COORDINATE TRAFFIC CONTROL WITH BASE PMO (451-8381) THROUGH ROICC.
 - THE CONTRACTOR SHALL PROVIDE ALL PAVEMENT MARKINGS AS REQUIRED BY NCDOT STANDARD SPECIFICATIONS FOR ROADS AND STRUCTURES (JULY 2006) SECTION 1205. PAVEMENT MARKINGS WILL INCLUDE CENTERLINES, DIRECTION ARROWS, ETC. SEE PAVEMENT MARKING DETAIL AND TRAFFIC DIRECTIONAL ARROW DETAIL ON SHEET C8. PAVEMENT MARKINGS SHALL BE PAINTED WITH WHITE HIGH BUILD ACRYLIC COATING TRAFFIC PAINT.
 - RESTRIP NEW ROADWAY TO MATCH EXISTING.
 - SEED ANY DISTURBED AREAS IN ACCORDANCE WITH BASE SEEDING SCHEDULE UPON COMPLETION OF CONSTRUCTION.
 - NO SECTION 404 WETLANDS WITHIN PROJECT BOUNDARIES.
 - JOBSITE SHALL BE KEPT CLEAR OF ALL DEBRIS AND TRASH.

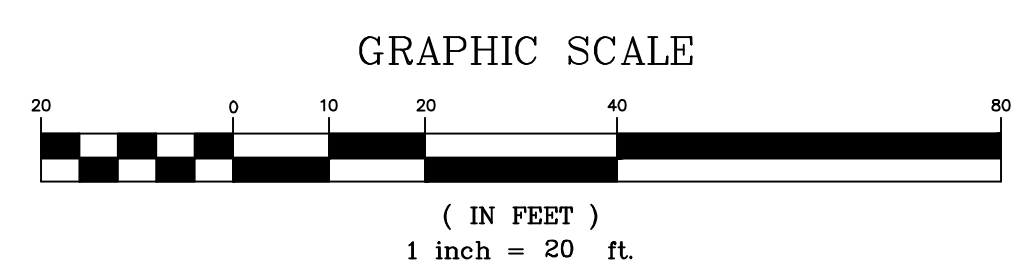

SITE PLAN-BLDG 84 ENTRANCE

		C-6	
		DEPARTMENT OF THE NAVY NAVAL FACILITIES ENGINEERING COMMAND MARINE CORPS BASE CAMP LEJEUNE, NORTH CAROLINA	
DES. THOMAS BRADSHAW		C11-0098	
DR. THOMAS BRADSHAW		TURNING LANE IMPROVEMENTS	
CHK. DAVID TOWLER		HOLCOMB BLVD	
SUBMITTED BY: DAVID TOWLER		BLDG 84 RIGHT TURN LANE	
DESIGN DIR. B. R. MARSHBURN, PE		PWO DRAWING NO.	
DATE:	8/10/2011	SIZE CODE IDENT NO.	60008027
		F 80091	CONST. CONTR. NO. N62470-11-B-0098
SCALE: AS SHOWN SPEC. 05-11-0098		SHEET 7 OF 9	

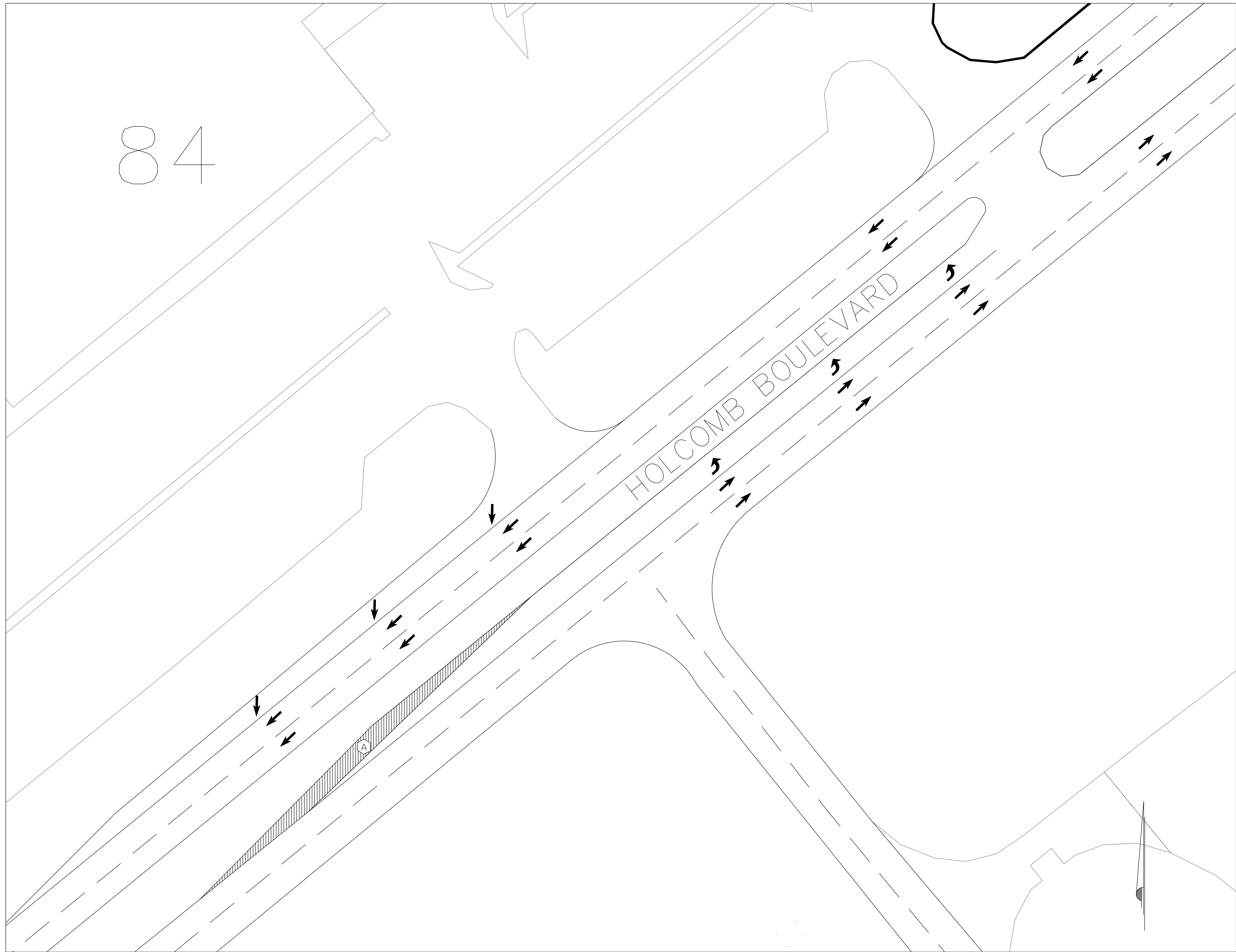

LEGEND	
EXISTING	NEW
CONCRETE CURBING	
ASPHALT	

ABBREVIATIONS	
AC	ASPHALTIC CONCRETE (ASPHALT)
ABC	AGGREGATE BASE COURSE
CD	CHECK DAM
UE	UNDERGROUND ELECTRIC
EW	EXISTING WATER LINE
NW	NEW WATER LINE
COM	COMMUNICATION LINE
TYP.	TYPICAL
PP	POWER POLE
CP	CONTROL POINT
T	TELEPHONE
FO	FIBER OPTIC
MH	MAN HOLE
MW	MON. WELL
LP	LIGHT POLE
FM	FORCE MAIN
CMP	CORRUGATED METAL PIPE

ELEVATIONS	
	(EXIST)
	PROPOSED

NOTES KEYED TO PLAN

- A EXTEND EXISTING HOLCOMB BLVD LEFT TURN LANE 100'. EXISTING TURNING LANE TAPER IS TO BE MAINTAINED.

GENERAL NOTES:

- CONTRACTOR SHALL LOCATE ALL UNDERGROUND UTILITIES PRIOR TO GROUND DISTURBING ACTIVITIES.
- CONTRACTOR SHALL COORDINATE ALL CONSTRUCTION ACTIVITIES WITH ROICC.
- MAINTAIN EXISTING ROADWAY CROWN OF 2% ON NEW SECTION OF TURN LANE FOR PROPER DRAINAGE.
- COMPACT SUBBASE TO 95% AND INSTALL 8" OF COMPACTED ABC CRUSHED STONE (NCDOT COMPLIANT) IN 4" LIFTS. TOTAL PAVED AREA APPROX. 125 SQ YDS.
- THE CONTRACTOR SHALL INSTALL NEW ROAD IN ACCORDANCE WITH TYPICAL NEW ROAD SECTION ON SHEET CB.
- SAW CUT EDGE OF EXISTING PAVEMENT TO ALLOW FOR SMOOTH TRANSITION FROM NEW TO EXISTING PAVEMENT.
- CONTRACTOR SHALL BE RESPONSIBLE FOR ALL TRAFFIC CONTROL NECESSARY TO SAFELY CONDUCT CONSTRUCTION ACTIVITIES. SURROUNDING BUILDINGS WILL REMAIN IN OPERATION DURING THE ENTIRE CONSTRUCTION PERIOD. THE CONTRACTOR SHALL CONDUCT OPERATIONS SO AS TO CAUSE THE LEAST POSSIBLE INTERFERENCE WITH NORMAL OPERATIONS TO THE MAXIMUM EXTENT POSSIBLE. CONTRACTOR SHALL COORDINATE TRAFFIC CONTROL WITH BASE PMO (451-8381) THROUGH ROICC.
- THE CONTRACTOR SHALL PROVIDE ALL PAVEMENT MARKINGS AS REQUIRED BY NCDOT STANDARD SPECIFICATIONS FOR ROADS AND STRUCTURES (JULY 2006) SECTION 1205. PAVEMENT MARKINGS WILL INCLUDE CENTERLINES, DIRECTION ARROWS, ETC. SEE PAVEMENT MARKING DETAIL AND TRAFFIC DIRECTIONAL ARROW DETAIL ON SHEET C3. PAVEMENT MARKINGS SHALL BE PAINTED WITH WHITE HIGH BUILD ACRYLIC COATING TRAFFIC PAINT.
- TURN LANE ARROWS ARE TO BE PROVIDED EVERY 100' FOR LANES MORE THAN 250' AND EVERY 75' FOR TURNS LANES LESS THAN 250'.
- REMOVE/REPLACE WHITE HIGH BUILD ACRYLIC EDGE LINES/SKIP LINES TO COMPENSATE FOR LENGTHENING OF TURN LANE.
- SEED ANY DISTURBED AREAS IN ACCORDANCE WITH BASE SEEDING SCHEDULE UPON COMPLETION OF CONSTRUCTION.
- NO SECTION 404 WETLANDS WITHIN PROJECT BOUNDARIES.
- JOBSITE SHALL BE KEPT CLEAR OF ALL DEBRIS AND TRASH.

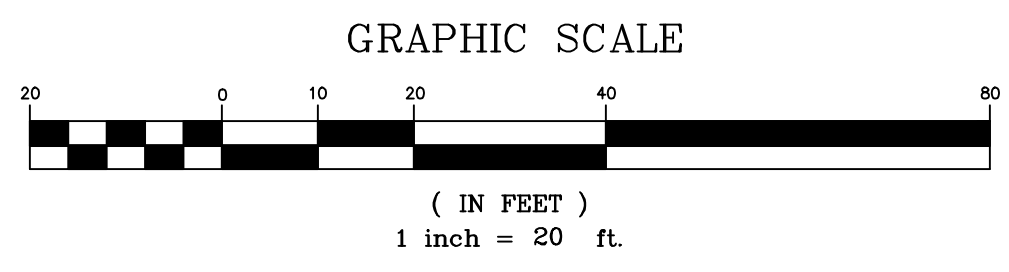

SITE PLAN-BLDG 84 LEFT TURN LANE

C-7	
DEPARTMENT OF THE NAVY NAVAL FACILITIES ENGINEERING COMMAND MARINE CORPS BASE CAMP LEJEUNE, NORTH CAROLINA	
C11-0098 TURNING LANE IMPROVEMENTS HOLCOMB BLVD BLDG 84 LEFT TURN LANE	
DES. THOMAS BRADSHAW	DATE: 8/10/2011
DR. THOMAS BRADSHAW	SIZE CODE IDENT NO: F 80091
CHK. DAVID TOWLER	PWO DRAWING NO. 60008028
SUBMITTED BY: DAVID TOWLER	CONST. CONTR. NO. N62470-11-B-0098
DESIGN DIR. B. R. MARSHBURN, PE	SCALE: AS SHOWN SPEC. 05-11-0098
SHEET 8 OF 9	

